

# Product specification

Date:2013-01-01 Index: 1

## Installation steps

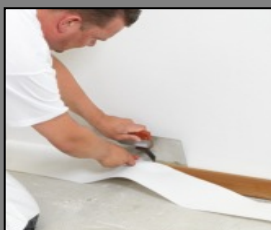

## Product: G 165GU

Description: Precoated and preglued Glass textile wall covering for indoor walls a

Composition: Texturized yarn of glassfiber in warp.  
Sliveryarn of glassfiber in weft.  
Precoated soft touch coating

## Technical data:

Properties	Unit	Min value	Nom value
Width	mm	990	1000
Length deviation	m	-0	
Thickness	mm		0,88
Total weight	g / m <sup>2</sup>	198	215
<b>Tensile strength</b>			
Warp direction	N / 5cm	408	480
Weft direction	N / 5cm	408	480

**Glue consumption** The glue is applied on the back side of the roll.

**Paint consumption** First coating Second coating  
m<sup>2</sup> / litre 9,2

### Facing side

Facing side is the INSIDE of the roll.

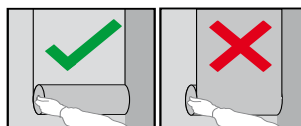

### Reverse side marking

Continous gray line 23 cm from the rolls edge.

### Pattern r

Offset match - tl



Pick over warpthrea warpt

## Allowed amount of marked spot faults

Roll length 15m Max 1  
Roll length 25 & 30m Max 2  
Roll length 50m Max 3

Note: A joint can occur in a roll and is considered as a spot fault.

## Certificates:

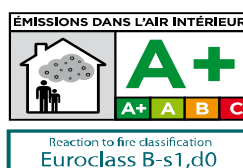

Storing: -10 to +50 de  
Use within 2 years



Information above is accurate to the best of our knowledge. Our products are subject to rigorous quality control along the produ

ensure conformance. Divergence within our tolerance may occur.

**Johns Manville AB, Box 7013, S-250 07 Helsingborg. Tel +46 42 25 05 00, Fax + 46 42 16 01 42**



and ceilings.

---

**Max value**

1010

242

---

---

**matching**

hread to thread.



1,6cm

d against pick under  
hread

---

---

degrees Celcius  
; after production

---

ction line to

